

SQG3-23 Base sounder VAD



Compliance EN54-3; EN54-23:2 010

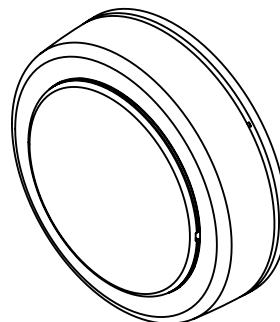
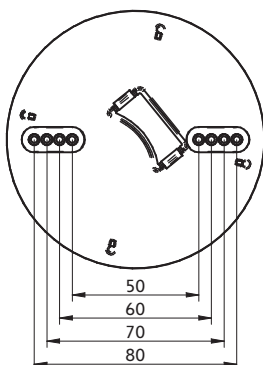

Table 1. Specification

| Feature | Value |
|-------------------------------|--|
| Supply voltage (conventional) | 18~35 Vdc |
| Cable size/type | 0.5~2.5mm ² /FIRETUF, FP200 or MICC |
| Current (high volume) | 11mA |
| Current (low volume) | 8.7mA |
| Sound output (high volume)* | 90 +/- 3dB(A) : All tones |
| Sound output (low volume)* | 80 +/- 3dB(A) : All tones |

| Feature | Value |
|------------------------|-----------------------------|
| Operating temperature | -10 to +55°C (93% ± 3%RH) |
| Material | ABS FR plastic |
| Environmental category | Type A= IP21C |
| Tones | 3, see section 4. |
| Flash rate | 0.5Hz |
| Flash on period | 60ms |

1. Mounting base



- (i) Knockout the required fixing holes.
- (ii) Fix to mounting surface using two suitable screws.
- (iii) Please ensure all cable entry points are sealed appropriately.

Note
If the base deforms on an uneven surface, loosen the screws or move to a flatter position.

2. Sounder/beacon assembly

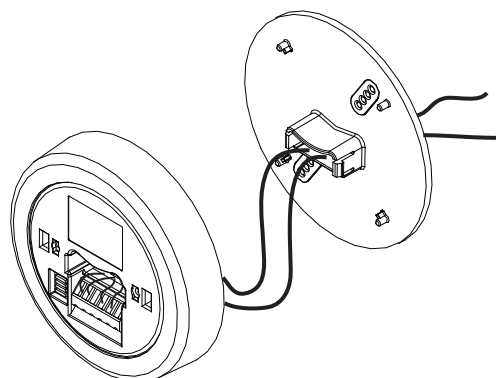

3. Connection details

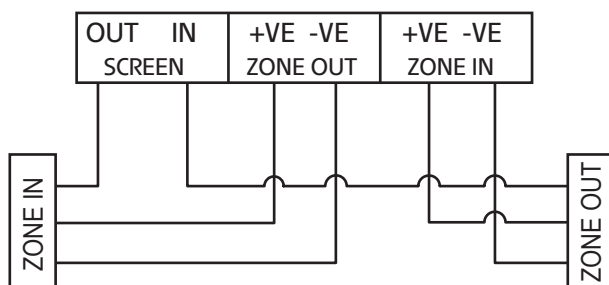

Note
Screen must be continuous along entire length of line.

4. Switch position meaning

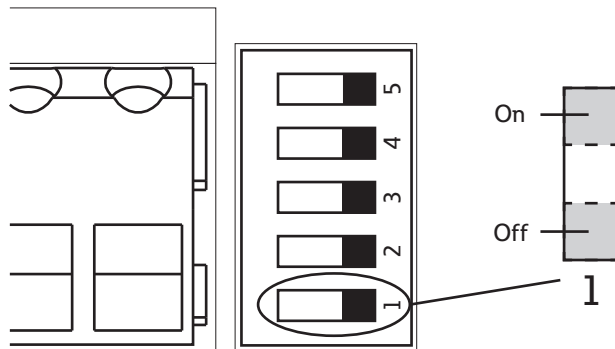

- 1, Sounder on/off (AV version only)
- 2, Volume high (off)/low (on)
- 3, Tones { Continuous: 3=On, 4=On (910Hz)
- 4, Tones { Bell: 3=On, 4=Off (1440 Hz)
- 5, Mode: On = N/A* Off = Conventional

*Switch 5 must be set to 'Off' in order to operate

5. VAD coverage area

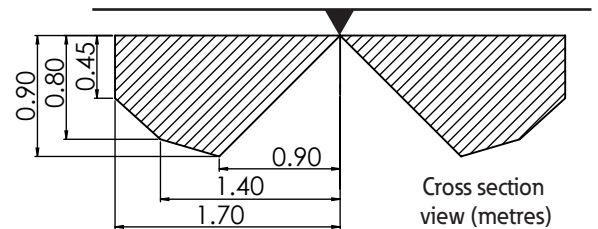
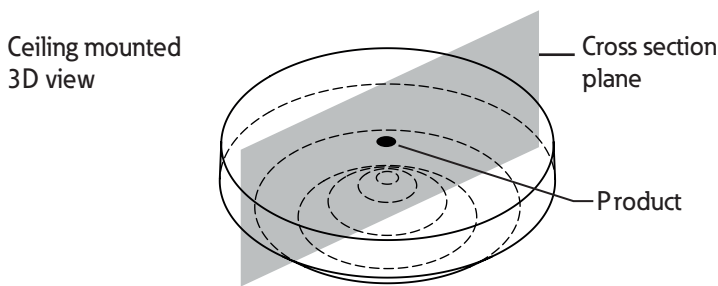

6. Fitting detector

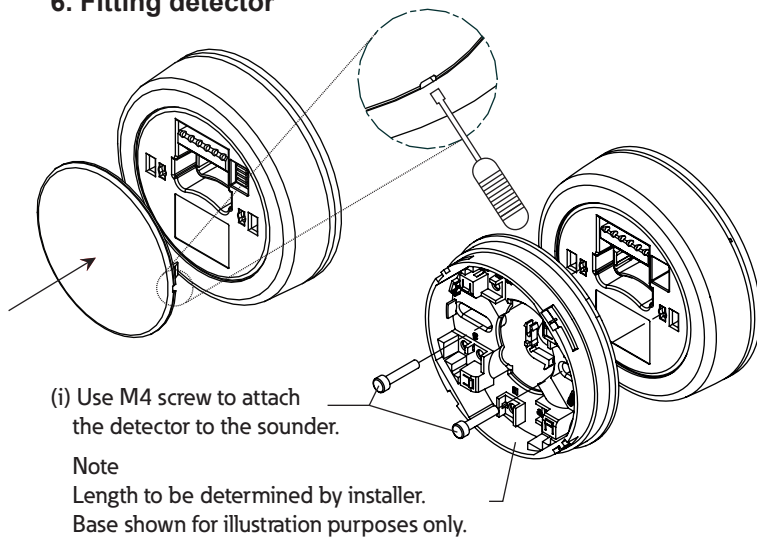

Manufactured By
Eaton Electrical Products Ltd
Llantarnam Park, Cwmbran, Gwent, NP44 3AW, UK
Tel: +44 (0)1633 628 500
Fax: +44 (0)1633 866 346
www.eaton.com
Made in the UK

7. Dimensions

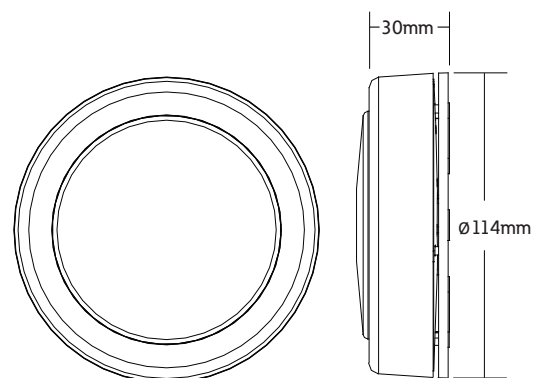

Notes.

The devices have no serviceable component so no maintenance is required.

*For full tone and polar node SPL data please refer to M14-003.